

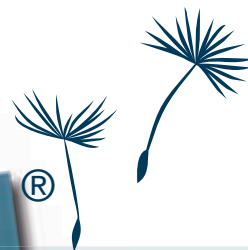

serie

TAL LIGHT



#### **Nuove Teste ad Angolo, quando la leggerezza è una priorità.**

Le nuove Teste ad Angolo della serie TAL sono state realizzate con l'obiettivo di ottenere un prodotto leggero, che potesse essere applicato su macchine ATC dove il peso dell'utensile è considerato una limitazione. Un prodotto più leggero quindi, che non vede limiti nelle possibili lavorazioni le quali rimangono le stesse di una normale Testa ad Angolo O.M.G.

Anche questa gamma si contraddistingue per la qualità con cui le teste vengono realizzate, che rimane sempre alta, come tutti i prodotti O.M.G.

Disponibili in diversi modelli, queste teste ad angolo vanno dalla piccola TAL07 alla grande TAL26.

#### ***New Angle Heads, when lightness is a priority.***

*The goal was to develop a product series that could be applied on machines with ATC where the weight of the head represents a limitation. A lighter weight product therefore, that does not limit the possible machining operations, with the same performance to our standard O.M.G. Angle Heads. This range also stands out for the high quality our customers have come to appreciate for all O.M.G. products.*

*Available in different models, these heads start from the small TAL07 to our large TAL26.*

FH

BAH

TA.CP

TA

MOX

HT

VH

TSI/TSX

T

MT-TC-TC3

Accessori  
Accessories

Appendice tecnica  
Technical supplement

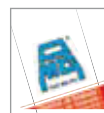

testa ad angolo - angle head

# TAL07



caratteristiche/features

$\phi$  7 M6 180 N   
  
 1-1 10000

peso/weight

4,5 kg 6,5 kg

rotazione/rotation

input output

prestazioni/performance

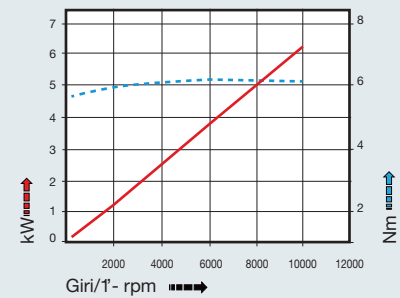

tipi mandrino disponibili / available spindle types

3 Weldon Whistle-Notch  $\phi$ 8- $\phi$ 10

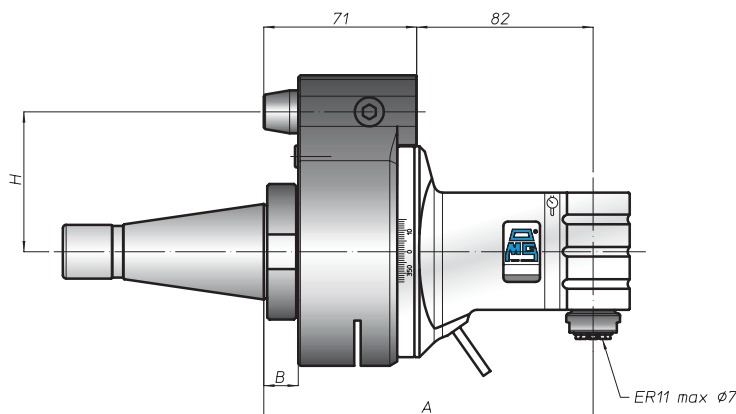
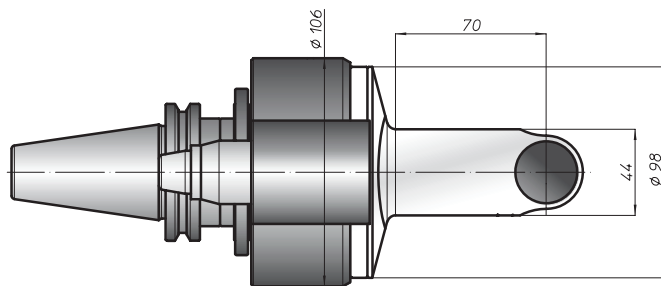
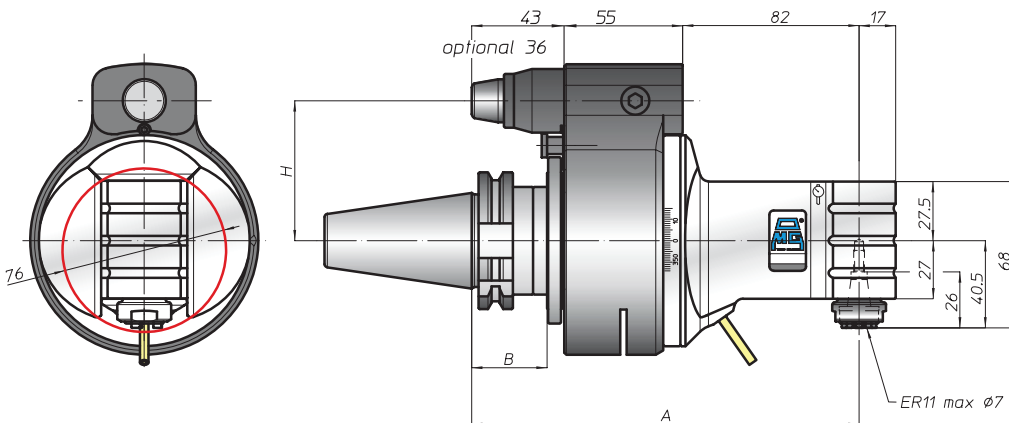

| CONO SHANK | size | H   |    |          |          |
|------------|------|-----|----|----------|----------|
|            |      | A   | B  | standard | optional |
| * DING9871 | 30   |     |    | 65       | -        |
|            | 40   |     |    | 80       | 110      |
|            | 45   |     |    | 80       | 110      |
| * CAT      | 40   | 180 | 35 | 65       | -        |
|            | 50   | 180 | 35 | 80       | 110      |
| * BT       | 40   |     |    | 65       |          |
|            | 50   | 188 | 45 | 80       | 110      |
| HSK        | 63   |     | 44 | 65       |          |
|            | 80   | 189 |    | 80       | 110      |
|            | 100  |     | 46 | 80       | 110      |
| CAPTO      | C5   |     |    | 65       |          |
|            | C6   | 184 | 39 |          |          |
|            | C8   |     |    | 80       | 110      |
| KM         | 63   |     |    | 65       |          |
|            | 80   | 180 |    | 80       | 110      |
|            | 100  |     |    | 80       | 110      |
| DIN2080    | -    | 150 | 13 | 65       | -        |
|            | 40   |     |    | 80       | 110      |
|            | 50   | 153 | 16 | 80       | 110      |
| NMTB       | 40   | 150 | 13 | 65       | -        |
|            | 50   | 153 | 16 | 80       | 110      |

\* Option: Dual Contact



# TAL10



caratteristiche/features

$\varnothing 10$ 
 M8
 400 N  
 1-1
 10000

peso/weight

4,5 kg
 6,7 kg

rotazione/rotation

input      output

prestazioni/performance

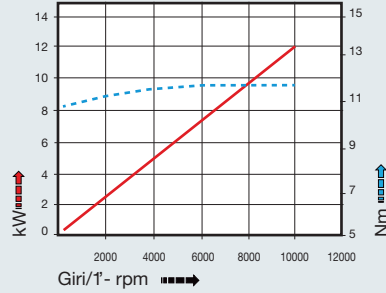

| CONO SHANK           | size | A   | B  | H        |          |
|----------------------|------|-----|----|----------|----------|
|                      |      |     |    | standard | optional |
| <br>DIN69871 *       | 30   | 180 | 35 | 65       | -        |
|                      | 40   |     |    | 80       | 110      |
|                      | 45   |     |    | 80       | 110      |
|                      | 50   |     |    | 80       | 110      |
| <br>ANSI B5.50 * CAT | 40   |     |    | 65       | -        |
|                      | 50   |     |    | 80       | 110      |
| <br>* BT             | 40   |     |    | 65       |          |
|                      | 50   | 188 | 45 | 80       | 110      |
| <br>DIN69893 HSK     | 63   |     | 44 | 65       |          |
|                      | 80   | 189 |    | 80       | 110      |
|                      | 100  |     | 46 | 80       | 110      |
| <br>ISO26623 CAPTO   | C5   |     |    | 65       |          |
|                      | C6   | 184 | 39 |          |          |
|                      | C8   |     |    | 80       | 110      |
| <br>KM               | 63   |     |    | 65       |          |
|                      | 80   | 180 |    | 80       | 110      |
|                      | 100  |     |    | 80       | 110      |
| <br>DIN2080          | -    | 150 | 13 | 65       | -        |
|                      | 40   |     |    |          |          |
|                      | -    | 153 | 16 | 80       | 110      |
| <br>ANSI B5.18 NMTB  | 40   | 150 | 13 | 65       | -        |
|                      | 50   | 153 | 16 | 80       | 110      |

tipi mandrino disponibili / available spindle types

- 1** DIN6499-ER      **2** Albero portafresse Milling shaft      **3** Weldon Whistle-Notch
- ER20**                      **Ø16**                      **Ø8-10-12**

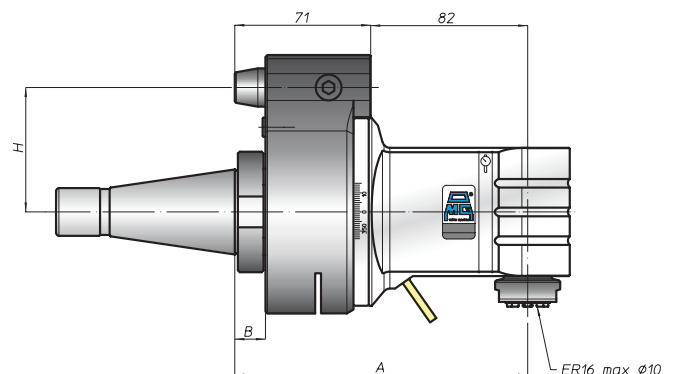
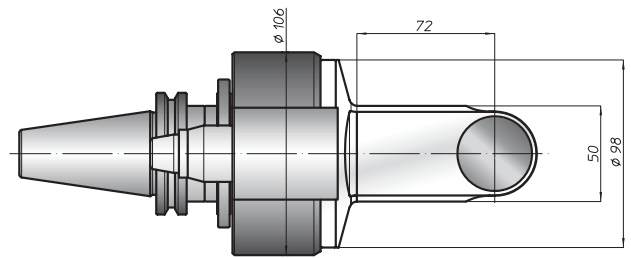
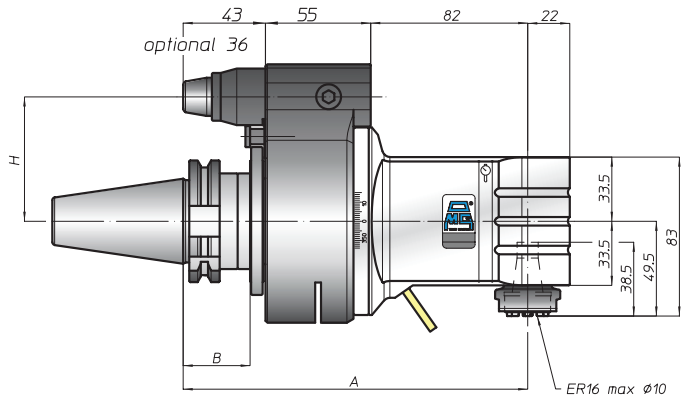
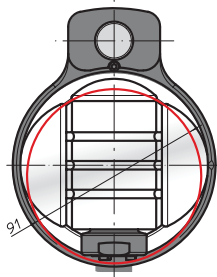

\* Option: Dual Contact



FH  
 BAH  
 TA.CP  
 TA  
 MOX  
 HT  
 VH  
 TSI/TSX  
 T  
 MT-TC-TC3  
 Accessori  
 Accessories  
 Appendice tecnica  
 Technical supplement

testa ad angolo - angle head

# TAL13



caratteristiche/features



  
 ø 13    M10    810 N

  
 1-1    8000

peso/weight

  
 5 kg    7,5 kg

rotazione/rotation

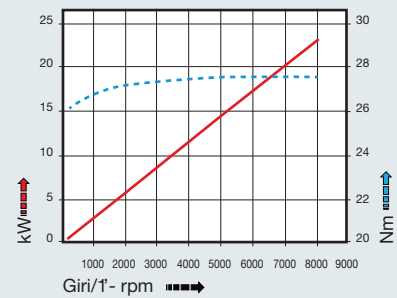

  
 input    output

prestazioni/performance

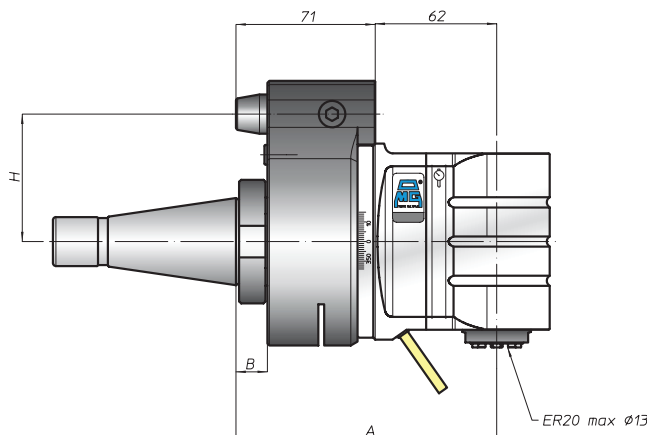
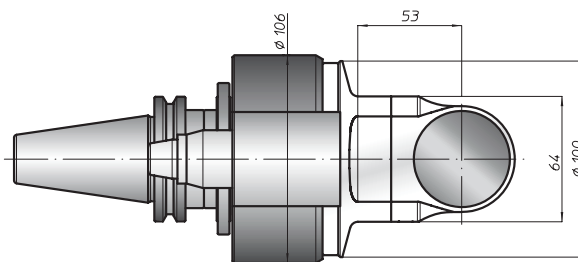
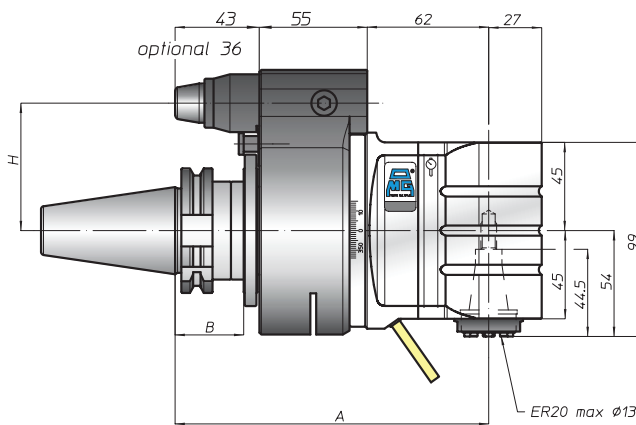
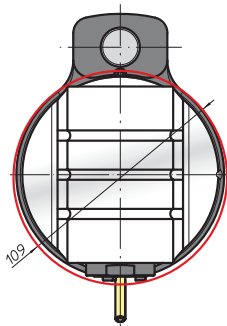

tipi mandrino disponibili / available spindle types

- 1** DIN6499-ER  
ER25
- 2** Albero portafrese  
Milling shaft  
Ø16-Ø22
- 3** Weldon  
Whistle-Notch  
Ø16
- 6** ABS  
Licenza KOMET®  
ABS25



| CONO SHANK      | size | H   |    |          |          |
|-----------------|------|-----|----|----------|----------|
|                 |      | A   | B  | standard | optional |
| * DIN9871       | -    |     |    | 65       | -        |
|                 | 40   | 160 | 35 | 80       | 110      |
|                 | 45   |     |    | 80       | 110      |
| 50              | 80   |     |    | 110      |          |
| * CAT           | 40   |     |    | 65       | -        |
|                 | 50   |     |    | 80       | 110      |
| * BT            | 40   |     |    | 65       |          |
|                 | 50   | 168 | 45 | 80       | 110      |
| HSK             | 63   |     | 44 | 65       |          |
|                 | 80   | 169 | 46 | 80       | 110      |
|                 | 100  |     |    | 80       | 110      |
| CAPTO           | C5   |     |    | 65       |          |
|                 | C6   | 164 | 39 | 80       | 110      |
|                 | C8   |     |    | 80       | 110      |
| KM              | 63   |     |    | 65       |          |
|                 | 80   | 160 |    | 80       | 110      |
|                 | 100  |     |    | 80       | 110      |
| DIN2080         | -    | 130 | 13 | 65       | -        |
|                 | 40   |     |    | 80       | 110      |
|                 | -    | 133 | 16 | 80       | 110      |
| ANSI B5.18 NMTB | 40   | 130 | 13 | 65       | -        |
|                 | 50   |     |    | 80       | 110      |

\* Option: Dual Contact



# TAL16



caratteristiche/features

ø 16 M12 1040 N

1-1 5000

peso/weight

5,8 kg 9,7 kg

rotazione/rotation

input output

prestazioni/performance

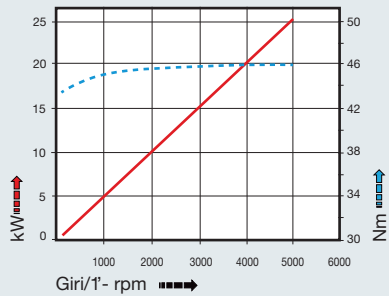

| CONO SHANK   | size | A   | B  | H        |          |
|--------------|------|-----|----|----------|----------|
|              |      |     |    | standard | optional |
| DIN9871 *    | -    | 172 |    | 65       | -        |
|              | 40   |     |    |          |          |
|              | 45   | 177 |    | 80       | 110      |
| ANSI B5.50 * | 40   | 172 |    | 65       | -        |
|              | 50   | 177 | 35 | 80       | 110      |
| * BT         | 40   | 172 |    | 65       |          |
|              | 50   | 185 | 45 | 80       | 110      |
| DIN9893      | 63   | 181 | 44 | 65       |          |
|              | 80   |     |    |          |          |
|              | 100  | 186 | 46 | 80       | 110      |
| ISO26623     | C5   | 176 |    | 65       |          |
|              | C6   |     | 39 |          |          |
|              | C8   | 181 |    | 80       | 110      |
| KM           | 63   | 172 |    | 65       |          |
|              | 80   |     |    |          |          |
|              | 100  | 177 |    | 80       | 110      |
| DIN2080      | -    | 147 | 13 | 65       | -        |
|              | 40   |     |    |          |          |
|              | -    | 150 | 16 | 80       | 110      |
| ANSI B5.18   | 40   | 142 | 13 | 65       | -        |
|              | 50   | 150 | 16 | 80       | 110      |

tipi mandrino disponibili / available spindle types

**1** DIN6499-ER ER32   
 **2** Albero portafresa Milling shaft Ø16-Ø22-Ø27-Ø32   
 **3** Weldon Whistle-Notch Ø20   
 **4** DIN69893-HSK HSK32   
 **5** COROMANT CAPTO® C3   
 **6** ABS Licenza KOMET® ABS32

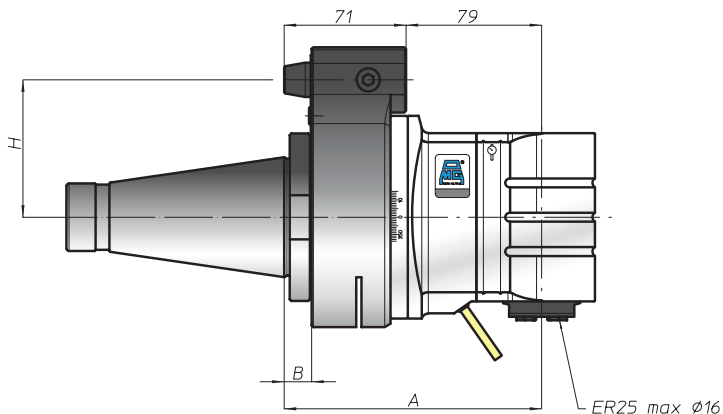
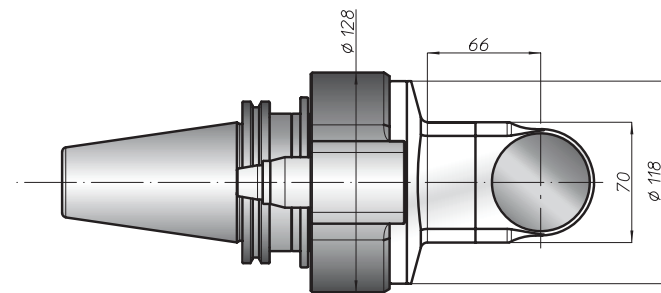
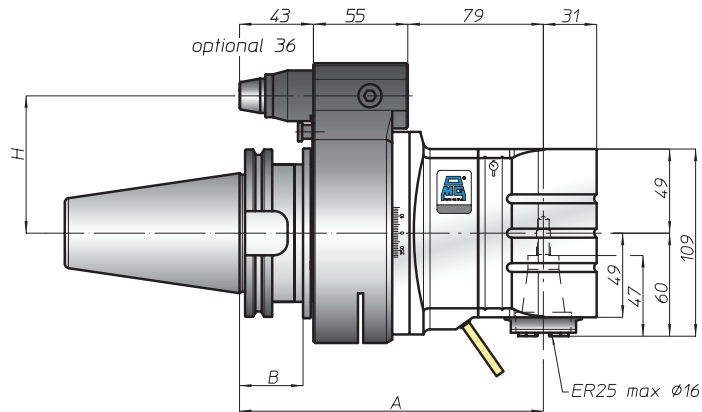
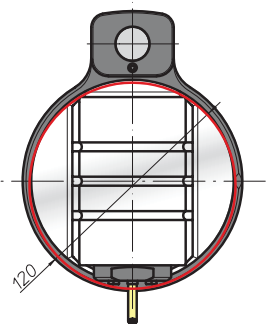

\*Option: Dual Contact

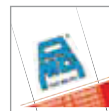

# TAL20



caratteristiche/features



peso/weight



11,5 kg

rotazione/rotation



input

output

prestazioni/performance

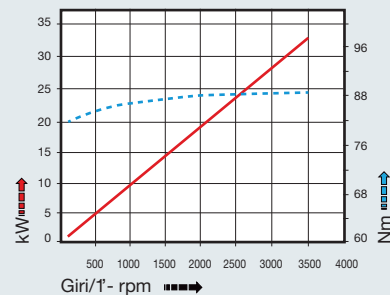

tipi mandrino disponibili / available spindle types

- 1** DIN6499-ER  
**ER40**
- 2** Albero portafrese  
Milling shaft  
**Ø22-Ø27-Ø32**
- 3** Weldon  
Whistle-Notch  
**Ø20-Ø25-Ø32**
- 4** DIN69893-HSK  
**HSK40**
- 5** COROMANT  
CAPTO®  
**C4**
- 6** ABS  
Licenza KOMET®  
**ABS40**

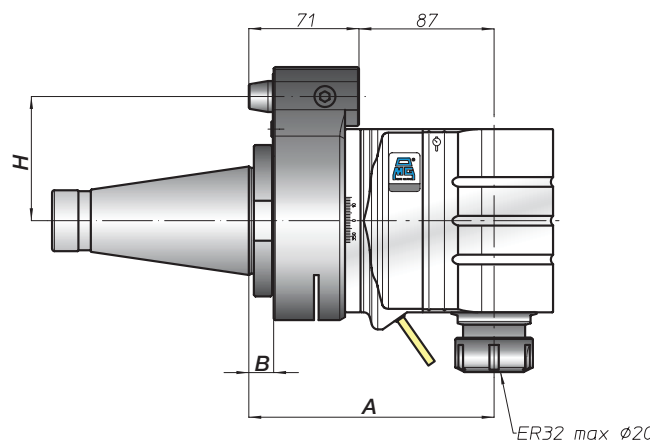
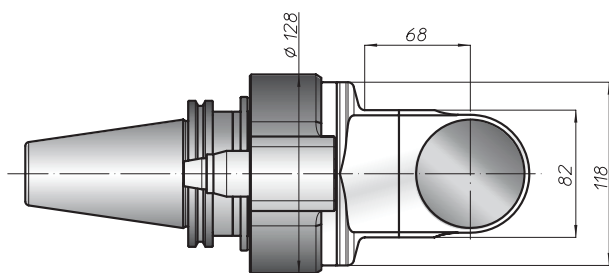
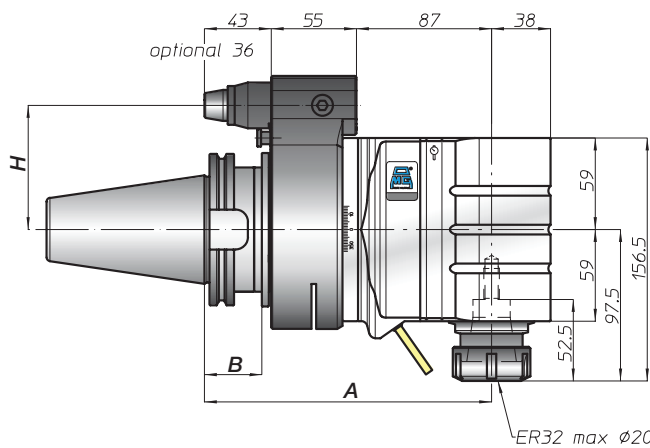
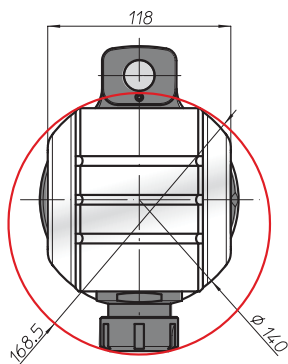

| CONO SHANK  | size | H   |    |          |          |
|-------------|------|-----|----|----------|----------|
|             |      | A   | B  | standard | optional |
| DIN69871 *  | -    | -   | -  | -        | -        |
| DIN69871 *  | 45   | -   | -  | 80       | 110      |
| DIN69871 *  | 50   | 185 | 35 | 80       | 110      |
| ANSIB5.50 * | -    | -   | -  | -        | -        |
| ANSIB5.50 * | 50   | -   | -  | 80       | 110      |
| BT *        | -    | -   | -  | -        | -        |
| BT *        | 50   | 193 | 45 | 80       | 110      |
| HSK         | -    | -   | -  | -        | -        |
| DIN69893    | 80   | 194 | -  | 80       | 110      |
| DIN69893    | 100  | -   | 46 | 80       | 110      |
| CAPTO       | -    | -   | -  | -        | -        |
| ISO26623    | -    | 189 | -  | 80       | 110      |
| ISO26623    | C8   | -   | -  | 80       | 110      |
| KM          | -    | -   | -  | -        | -        |
| KM          | 80   | 185 | -  | 80       | 110      |
| KM          | 100  | -   | -  | 80       | 110      |
| DIN2080     | -    | -   | -  | -        | -        |
| DIN2080     | -    | 158 | 16 | 80       | 110      |
| DIN2080     | 50   | -   | -  | 80       | 110      |
| NMTB        | -    | -   | -  | -        | -        |
| ANSIB5.18   | 50   | 158 | 16 | 80       | 110      |

\* Option: Dual Contact



# TAL26



caratteristiche/features

peso/weight

prestazioni/performance



19 kg

rotazione/rotation



input



output

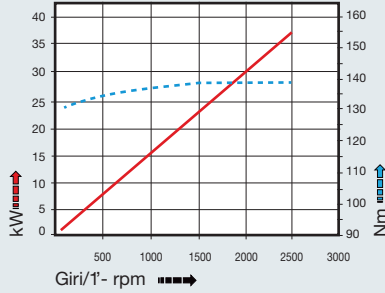

| CONO SHANK  | size | A   | B   | H        |          |
|-------------|------|-----|-----|----------|----------|
|             |      |     |     | standard | optional |
| * DING9871  | -    | 192 | 35  | -        | -        |
|             | 45   |     |     | 110      | -        |
| * ANSIB5.50 | -    | 196 | 110 | -        | -        |
|             | 50   |     |     | 110      | -        |
| * BT        | -    | 200 | 45  | 110      | -        |
|             | 50   |     |     | 110      | -        |
| HSK         | -    | 201 | 46  | 110      | -        |
|             | 80   |     |     | 110      | -        |
| DING9893    | -    | 196 | 110 | -        | -        |
|             | 100  |     |     | 110      | -        |
| CAPTO       | -    | 196 | 110 | -        | -        |
|             | C8   |     |     | 110      | -        |
| KM          | -    | 192 | 110 | -        | -        |
|             | 100  |     |     | 110      | -        |
| DIN2080     | -    | 165 | 16  | 110      | -        |
|             | 50   |     |     | 110      | -        |
| NMTB        | -    | 165 | 16  | 110      | -        |
|             | 50   |     |     | 110      | -        |

tipi mandrino disponibili / available spindle types

- 1 DIN6499-ER  
**ER50**
- 2 Albero portafresa  
Milling shaft  
**Ø16-Ø27-Ø32-Ø40**
- 3 Weldon  
Whistle-Notch  
**Ø32**
- 4 DIN69893-HSK  
**HSK63**
- 5 COROMANT  
CAPTO®  
**C4-C5-C6**
- 6 ABS  
Licenza KOMET®  
**ABS50**

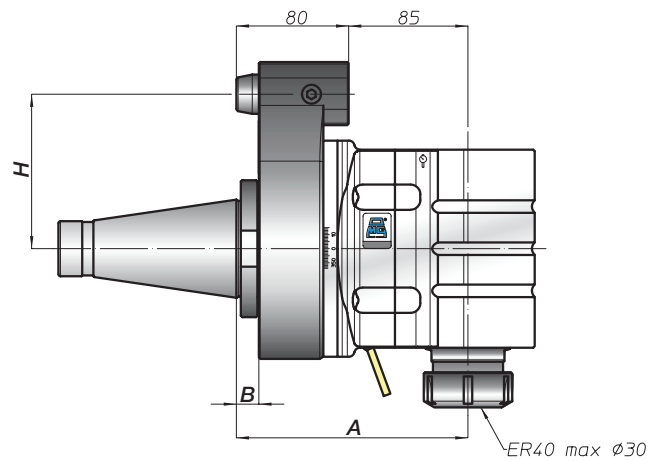
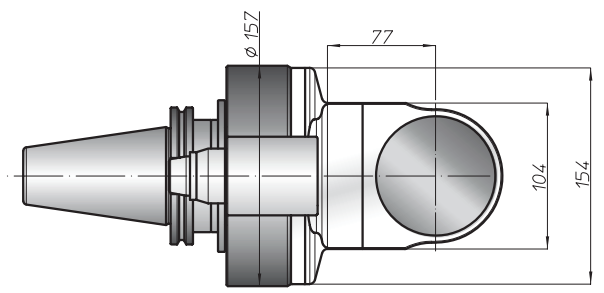
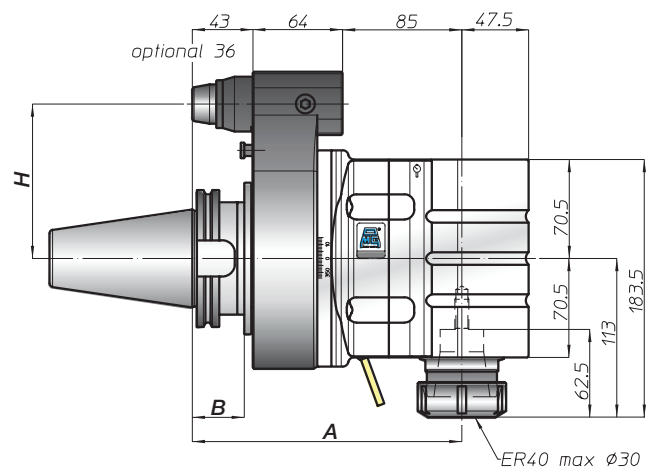
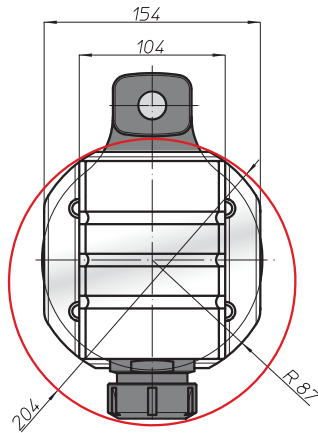

\* Option: Dual Contact

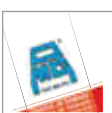

FH  
BAH  
TA.CP  
TA  
MOX  
HT  
VH  
TSI/TSX  
T  
MT-TC-TC3  
Accessori  
Accessories  
Appendice tecnica  
Technical supplement

testa ad angolo - angle head

# TAL26.40



caratteristiche/features



  
 ø 26    M20    3020 N  

  
 1-1    2500

peso/weight



19 kg

rotazione/rotation



input



output

prestazioni/performance

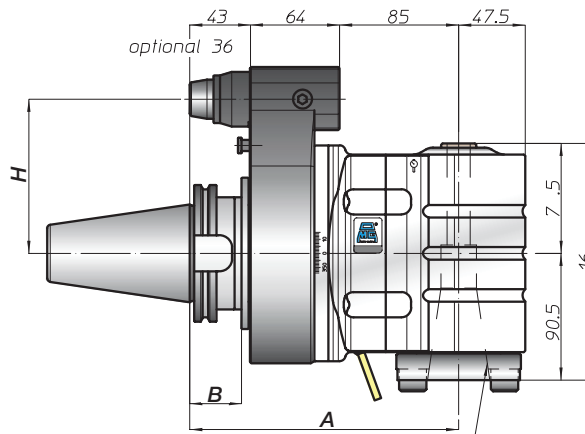
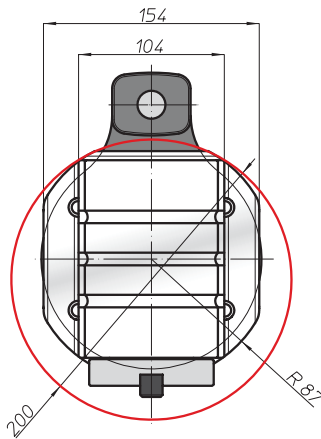
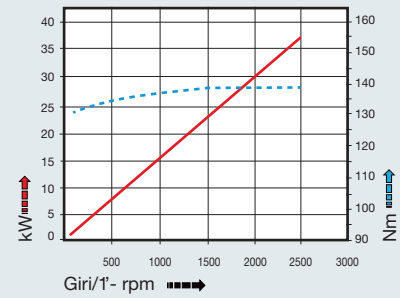

Cono 40 DIN2079

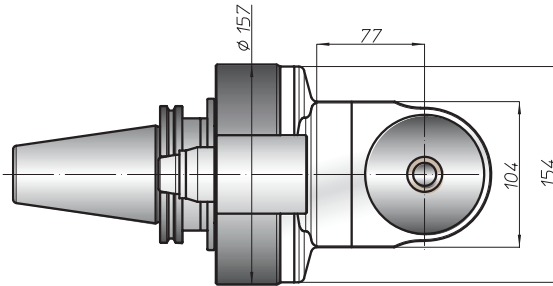

**Nota:**

- nel mandrino DIN2079 si possono utilizzare coni DIN2080-40, DIN69871-A40, MAS403-BT40

**Note:**

- on the spindle DIN2079 you can use shank DIN2080-40, DIN69871-A40, MAS403-BT40

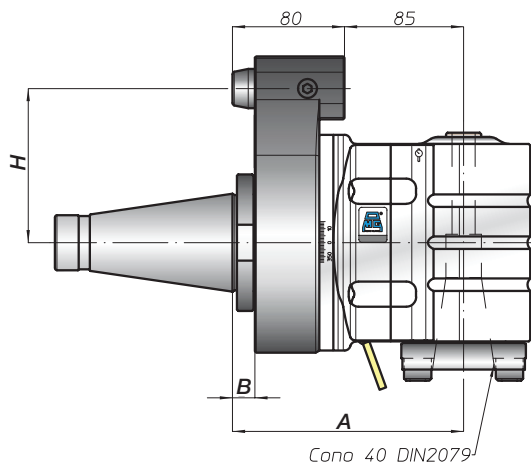

Cono 40 DIN2079

| CONO SHANK  | size | H   |    |                     |
|-------------|------|-----|----|---------------------|
|             |      | A   | B  | standard / optional |
| DIN69871 *  | -    | -   | -  | -                   |
| DIN69871 *  | 45   | -   | -  | 110 -               |
| DIN69871 *  | 50   | 192 | 35 | 110 -               |
| ANSIB5.50 * | -    | -   | -  | -                   |
| ANSIB5.50 * | 50   | -   | -  | 110 -               |
| BT *        | -    | -   | -  | -                   |
| BT *        | 50   | 200 | 45 | 110 -               |
| HSK         | -    | -   | -  | -                   |
| DIN69893    | 80   | 201 | 46 | 110 -               |
| DIN69893    | 100  | -   | -  | -                   |
| CAPTO       | -    | -   | -  | -                   |
| ISO26623    | -    | 196 | -  | 110 -               |
| ISO26623    | C8   | -   | -  | -                   |
| KM          | -    | -   | -  | -                   |
| KM          | -    | 192 | -  | 110 -               |
| KM          | 100  | -   | -  | -                   |
| DIN2080     | -    | -   | -  | -                   |
| DIN2080     | -    | -   | -  | -                   |
| DIN2080     | 50   | 165 | 16 | 110 -               |
| NMTB        | -    | -   | -  | -                   |
| ANSIB5.18   | 50   | 165 | 16 | 110 -               |

\* Option: Dual Contact

FH

BAH

TA-CP

TA

MOX

HT

VH

TSI/TSX

T

MT-TC-TC3

Accessori  
Accessories

Appendice tecnica  
Technical supplement

