

- Chiave inclusa
- Key included
- Schlüssel inbegriffen

Cod. MT	Mandrino Spindel Spindel	I	RPM	Coppia Max Max Torque Max Drehmoment	Reversibile lato mandrino/contromandrino Reversible sub/main spindle side Umkehrbare Spindel-seite/ Gegenspindel-seite	Lubrificazione int. Coolant through Innenkuehlung	Lubrificazione est. Ext. coolant Aussenkuehlung	A	B	CHIAVI NON INCLUSE Keys not included Schlüssel nicht inbegriffen		
DW 02290320	ERA20	1:1	6000	35Nm	X	-	X	66,5	46	CHUB22	CHTAER20ZC	OKU0290009
DW 02290420	ERA20	1:1	6000	35Nm	X	P=70bar	X	66,5	56	CHUB22	CHTAER20ZC	OKU0290009
DW 02290325	ERA25	1:1	6000	35Nm	X	-	X	70	46	CHUB27	CHTAER25ZC	OKU0290009
DW 02290425	ERA25	1:1	6000	35Nm	X	P=70bar	X	70	56	CHUB27	CHTAER25ZC	OKU0290009

**DN SOLUTIONS (DOOSAN) BMT 45**

MOD: LYNX 220 M/LM/LMS/LY/LSY - LYNX 2100 M/LM/LMS/LY/LSY - LYNX 2105LY - PUMA MX1600 16ST. - PUMA TT1300SY/SYY

MODULO MOTORIZZATO ASSIALE H=65mm  
Axial driven tool H=65mm  
Axial angetriebenes Werkzeug H=65mm

Subject to change without notice.

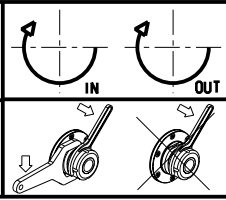

**M.T. srl**  
Via Casino Albini 480  
Tel. 0541/956034-957884  
Fax 0541/956341  
47842 S. GIOVANNI IN M. (RN)  
e-mail: mtma@mtmarchetti.com  
http://www.mtmarchetti.com



DW 0150-1-00