

- Chiave inclusa
- Key included
- Schluessel inbegriffen

Cod. MT	Mandrino Spindle Spindel	I	RPM	Coppia Max Max Torque Max Drehmoment	Lubrificazione int. Coolant through Innenkuehlung	Lubrificazione est. Ext. coolant Aussenkuehlung	A	A1	A2	D	L	CHIAVI NON INCLUSE Keys not included Schluessel nicht einbegriffen	
MNZ0440116	ER16	1:1	12000	40Nm	-	X	70.76	-	-	-	-	MNZ0410005	CHSTER16
MNZ0440120	ER20	1:1	12000	40Nm	-	X	72.16	-	-	-	-	MNZ0410005	CHSTER20
MNZ0440125	ER25	1:1	12000	40Nm	-	X	73.16	-	-	-	-	MNZ0410005	CHSTER25
MNZ0440225	ER25	1:1	12000	40Nm	P=70bar	X	83.66	-	-	-	-	MNZ0410005	CHSTER25
MNZ0440132	ER32	1:1	12000	40Nm	-	X	76.16	-	-	-	-	MNZ0410005	CHSTER32
MNZ0440232	ER32	1:1	12000	40Nm	P=70bar	X	86.66	-	-	-	-	MNZ0410005	CHSTER32
MNZ0440416	Ø16x17	1:1	12000	40Nm	-	X	-	54.5	-	16	17	MNZ0410005	CH_VTCROCE_M08
MNZ0440422	Ø22x19	1:1	12000	40Nm	-	X	-	54.5	-	22	19	MNZ0410005	CH_VTCROCE_M10
MNZ0440419	Ø3/4"x3/4"	1:1	12000	40Nm	-	X	-	54.5	-	3/4"	3/4"	MNZ0410005	CH_VTCROCE_M08
MNZ0440308	WELDON 8	1:1	12000	40Nm	-	X	-	-	72.5	-	-	-	-
MNZ0440310	WELDON 10	1:1	12000	40Nm	-	X	-	-	74.5	-	-	-	-
MNZ0440312	WELDON 12	1:1	12000	40Nm	-	X	-	-	77	-	-	-	-
MNZ0440316	WELDON 16	1:1	12000	40Nm	-	X	-	-	79.5	-	-	-	-

DMG-MORI
 NZ1500/2000 - NZX1500/2000 - NZX2500 (BMT40) - NL1500/2000/2500 20 STAZ. - NLX1500/2000/2500 20 STAZ. - NTX500 (BMT40)
 NTX1000/2000 - NTX1000/2000/2500/3000 2ND GEN. - NRX2000 - ALC/ALX1500/2000/2500 (BMT40) - NZ DUE/TRE/QUATTRO (BMT40)

MODULO MOTORIZZATO RADIALE 12000 RPM
 Radial driven tool 12000 rpm
 Radial angetriebenes Werkzeug 12000 rpm

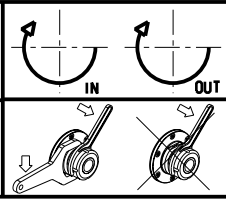

M.T. srl
 Via Casino Albini 480
 Tel. 0541/956034-957884
 Fax 0541/956341
 47842 S. GIOVANNI IN M. (RN)
 e-mail: mtma@tmarchetti.com
 http://www.tmmarchetti.com

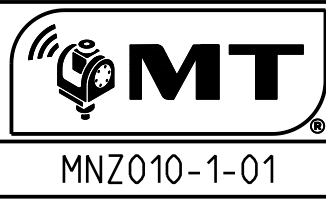

Subject to change without notice.