

- Chiave inclusa
- Key included
- Schlüssel inbegriffen

Cod. MT	Mandrino Spindle Spindel	I	RPM	Coppia Max Max Torque Max Drehmoment	Reversibile lato mandrino/contromandrino Reversible sub/main spindle side Umkehrbare Spindel-seite/ Gegenspindel-seite	Lubr.interna Coolant through Innenkuehlung	Lubr.esterna Ext. coolant Aussenkuehlung	CHIAVI NON INCLUDE Keys not included Schlüssel nicht einbegriffen		
					X	-	X	C HUB27	C HTAER25ZC	OKU0290009
MNZ0570325	ERA25	1:1	12000	40Nm	X	-	X	C HUB27	C HTAER25ZC	OKU0290009
MNZ0570425	ERA25	1:1	12000	40Nm	X	P=30bar	X	C HUB27	C HTAER25ZC	OKU0290009

DMG-MORI

NZ1500/2000 - NZX1500/2000 - NZX2500 (BMT40) - NL1500/2000/2500 20 STAZ. - NLX1500/2000/2500 20 STAZ. - NTX500 (BMT40)
 NTX1000/2000 - NTX1000/2000/2500/3000 2ND GEN. - NRX2000 - ALC/ALX1500/2000/2500 (BMT40) - NZ DUE/TRE/QUATTRO (BMT40)

MODULO MOTORIZZATO RADIALE DISASSATO IN Z 36mm 12000 RPM

Radial driven tool re-directed in Z by 36mm 12000 rpm

Radial angetriebenes Werkzeug achsversetzt in Z um 36mm 12000 rpm

Subject to change without notice.

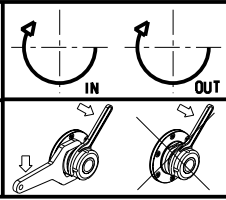

M.T. srl
 Via Casino Albini 480
 Tel. 0541/956034-957884
 Fax 0541/956341
 47842 S. GIOVANNI IN M. (RN)
 e-mail: mtma@mtmarchetti.com
 http://www.mtmarchetti.com



MNZ033-1-11