

- Chiave inclusa
- Key included
- Schlüssel inbegriffen

Cod. MT	Mandrino Spindle Spindel	I	RPM	Coppia Max Max Torque Max Drehmoment	Lubrificazione est. Ext. coolant Aussenkuhlung	Lubrificazione int. Coolant through Innenkuehlung	A	A1	H	Tipo Torretta Turret Type Revolver Typ	CHIAVI NON INCLUSE Keys not included Schlüssel nicht einbegriffen		
											CHUB41	CHSTER32	
HAS0010232	ER32	1:1	6000	70Nm	X	-	107.26	-	104.85	VDI STANDARD	CHUB41	CHSTER32	-
HAS0010132	ER32	1:1	6000	70Nm	X	P=30bar	110.46	-	104.85	VDI STANDARD	CHUB41	CHSTER32	-
HAS0010325	ERA25	1:1	6000	70Nm	X	-	74	-	104.85	VDI STANDARD	CHUB42	CHTAER25ZC	CHUB27
HAS0010525	WELDON25	1:1	6000	70Nm	X	-	-	97.1	104.85	VDI STANDARD	-	-	-
HAS0020232	ER32	1:1	6000	70Nm	X	-	107.26	-	117.55	HYBRID 12 TURRET	CHUB41	CHSTER32	-
HAS0020132	ER32	1:1	6000	70Nm	X	P=30bar	110.46	-	117.55	HYBRID 12 TURRET	CHUB41	CHSTER32	-
HAS0020325	ERA25	1:1	6000	70Nm	X	-	74	-	117.55	HYBRID 12 TURRET	CHUB42	CHTAER25ZC	CHUB27
HAS0020525	WELDON25	1:1	6000	70Nm	X	-	-	97.1	117.55	HYBRID 12 TURRET	-	-	-

HAAS

MOD: SL10/20/30

MODULO MOTORIZZATO ASSIALE VDI40

Axial driven tool VDI40

Axial angetriebenes Werkzeug VDI40

Subject to change without notice.

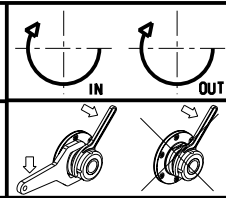

M.T. srl

Via Casino Albini 480
Tel. 0541/956034-957884
Fax 0541/956341

47842 S. GIOVANNI IN M. (RN)
e-mail: mtma@mtmarchetti.com
http://www.mtmarchetti.com



HAS150-1-10

09/2024