

ATTENZIONE - ATTENTION - ACHTUNG

- VERIFICARE LE MISURE DI INGOMBRO PER POSSIBILE INTERFERENZA SU ALCUNI MODELLI DI MACCHINE
- Please check the overall sizes for possible interferences on some machine models
- Bitte überprüfen sie das ausmass um mögliche interferenzen auf einigen maschinen modellen zu vermeiden

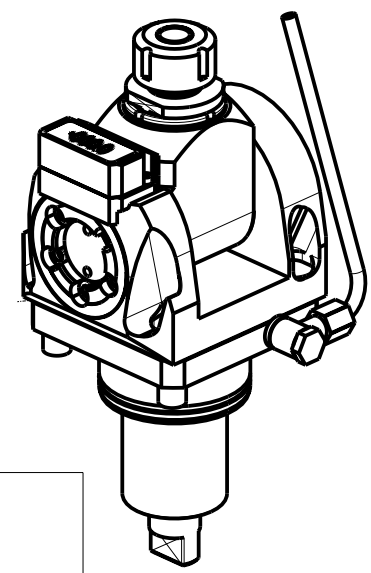

| Cod. MT | Mandrino Spindle Spindel | I | RPM | Coppia Max Max Torque Max Drehmoment | Reversibile lato mandrino/contromandrino Reversible sub/main spindle side Umkehrbare Spindelseite/ Gegenspindelseite | Lubrificazione est. Ext. coolant Auslenkuehlung | A | A1 | D | L | CHIAVI INCLUSE Keys included Schluessel inbegriffen | | |
|-------------|--------------------------------|-----|------|--|---|---|-------|----|------|------|---|--------|---------|
| | | | | | | | | | | | CH_VTCROCE_M08 | CHUB36 | CHESL10 |
| DW 01850120 | ER20 | 1:1 | 6000 | 40Nm | X | X | 85.16 | - | - | - | CHSTER20 | CHUB36 | CHESL10 |
| DW 01850125 | ER25 | 1:1 | 6000 | 40Nm | X | X | 86.16 | - | - | - | CHSTER25 | CHUB36 | CHESL10 |
| DW 01850516 | Ø16x17 | 1:1 | 6000 | 40Nm | X | X | - | 65 | 16 | 17 | CH_VTCROCE_M08 | CHUB36 | CHESL10 |
| DW 01850522 | Ø22x19 | 1:1 | 6000 | 40Nm | X | X | - | 66 | 22 | 19 | CH_VTCROCE_M10 | CHUB36 | CHESL10 |
| DW 01850519 | Ø3/4"x3/4" | 1:1 | 6000 | 40Nm | X | X | - | 65 | 3/4" | 3/4" | CH_VTCROCE_M08 | CHUB36 | CHESL10 |

HYUNDAI-WIA (KIA)

SKT200TTM/TTMS/TTSY - LM2000TTM/TTMS/TTSY - L2000/2100/2600/3000Y/SY - L300M/LM/MS/LMS - LV450RM/LM
 SKT250TTM/TTMS/TTSY - LM2500TTM/TTMS/TTSY - SKT250M/LM/MS - SKT300M/LM/MS - SKT-V3RM/LM - KM2600MTTS - HD2600/3100 (BMT65)

MODULO MOTORIZZATO ORIENTABILE ±90° CON NONIO DIGITALE H=54mm

±90° adjustable angle driven tool with digital display H=54mm

Angetriebenes Werkzeug schwenkbar ±90° mit digital display H=54mm

Subject to change without notice.

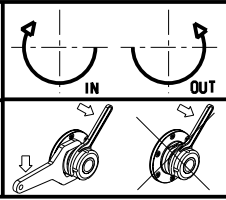

M.T. srl
 Via Casino Albini 480
 Tel. 0541/956034-957884
 Fax 0541/956341
 47842 S. GIOVANNI IN M. (RN)
 e-mail: mtma@mtmarchetti.com
 http://www.mtmarchetti.com



KIA333-3-01