

- Chiave inclusa
- Key included
- Schluessel inbegriffen

Cod. MT	Mandrino Spindle Spindel	I	RPM	Coppia Max Max Torque Max Drehmoment	Lubrificazione int. Coolant through Innenkuehlung	Lubrificazione est. Ext. coolant Aussenkuehlung	A	B	A1	D	L	CHIAVI NON INCLUDE Keys not included Schluessel nicht einbegriffen	
MZK0410132	ER32	1:1	6000	70Nm	-	X	99.7	58.5	-	-	-	OKU0650004	CHSTER32
MZK0410232	ER32	1:1	6000	70Nm	P=70bar	X	99.7	69.5	-	-	-	OKU0650004	CHSTER32
MZK0410140	ER40	1:1	6000	70Nm	-	X	103.7	58.5	-	-	-	OKU0650004	CHSTER40
MZK0410240	ER40	1:1	6000	70Nm	P=70bar	X	103.7	69.5	-	-	-	OKU0650004	CHSTER40
MZK0410527	Ø27x21	1:1	6000	70Nm	-	X	-	58.5	78.5	27	21	CHUB41	CH_VTCROCE_M12
MZK0410522	Ø22x19	1:1	6000	70Nm	-	X	-	58.5	78.5	22	19	CHUB41	CH_VTCROCE_M10

MAZAK

MOD: MULTIPLEX 610/6100 12 STAZIONI - MULTIPLEX 620/6200 16 STAZIONI
 HYPER QUADREX 100/150MSX/MSY 12 STAZIONI - HYPER QUADREX 200-250MS/MSY 16 STAZIONI

MODULO MOTORIZZATO ASSIALE

Axial driven tool

Axial angetriebenes Werkzeug

Subject to change without notice.

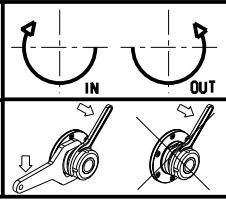

M.T. srl
 Via Casino Albini 480
 Tel. 0541/956034-957884
 Fax 0541/956341
 47842 S. GIOVANNI IN M. (RN)
 e-mail: mtma@mtmarchetti.com
 http://www.mtmarchetti.com



MZK150-4-10