

- Chiave inclusa
- Key included
- Schlüssel inbegriffen

NEW  
NEW

Cod. MT	Mandrino Spindle Spindel	I	RPM	Coppia Max Max Torque Max Drehmoment	Lubr.interna Coolant through Innenkuehlung	Lubr.esterna Ext. coolant Aussenkuehlung	A	B	CHIAVI NON INCLUDE Keys not included Schlüssel nicht einbegriffen		
									C HUB30	CHTAER32ZC	OKU0430007
MZK0310332	ERA32	1:1	6000	70Nm	-	X	71	60.5	C HUB30	CHTAER32ZC	OKU0430007
MZK0310432	ERA32	1:1	6000	70Nm	P=70bar	X	71	73	C HUB30	CHTAER32ZC	OKU0430007
MZK0310132	ER32	1:1	6000	70Nm	-	X	99.7	60.5	-	CHSTER32	OKU0430007
MZK0310232	ER32	1:1	6000	70Nm	P=70bar	X	99.7	73	-	CHSTER32	OKU0430007
MZK0310140	ER40	1:1	6000	70Nm	-	X	101.7	60.5	-	CHSTER40	OKU0430007
MZK0310240	ER40	1:1	6000	70Nm	P=70bar	X	101.7	73	-	CHSTER40	OKU0430007

**MAZAK**

MOD: QUICK TURN SMART 150M/200M/250M - QT 200/250M 12ST.  
QTC100/200/300M - QTE100/200/300M - QTU 200/250/350M - QT-Ez 8/10/12M

MODULO MOTORIZZATO ASSIALE H=80mm

Axial driven tool H=80mm

Axial angetriebenes Werkzeug H=80mm

Subject to change without notice.

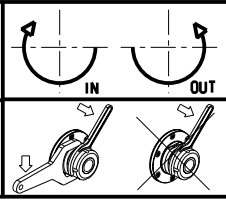

**M.T. srl**  
Via Casino Albini 480  
Tel. 0541/956034-957884  
Fax 0541/956341  
47842 S. GIOVANNI IN M. (RN)  
e-mail: mtma@mtmarchetti.com  
http://www.mtmarchetti.com



MZK150-7-10