

ATTENZIONE - ATTENTION - ACHTUNG

- Per lo smontaggio degli utensili utilizzare sempre la chiave di contrasto come indicato nel manuale d'uso.
- For disassembly of the tools use always the contrast key as mentioned in the user instructions.
- Fuer das Abmontieren der Werkzeuge immer den Gegenschlüssel benutzen wie in der Bedienungsanleitung erwaeht.

- Chiave inclusa
- Key included
- Schluessel inbegriffen

| Cod. MT | Mandrino Spindle Spindel | I | RPM | Coppia Max Max Torque Max Drehmoment | Reversibile lato mandrino/contromandrino Reversible sub/main spindle side Umkehrbare Spindel-seite/ Gegenspindel-seite | Lubr. interna Coolant through Innenkuehlung | Lubr. esterna Ext. coolant Aussenkuehlung | A | A1 | B | D | L | CHIAVI NON INCLUDE Keys not included Schluessel nicht einbegriffen | |
|------------|--------------------------|-----|------|--------------------------------------|------------------------------------------------------------------------------------------------------------------------|---------------------------------------------|-------------------------------------------|-------|------|----|----|----|--------------------------------------------------------------------------|----------------|
| NKM0021620 | ER20 | 1:1 | 6000 | 50Nm | X | - | X | 80.66 | - | 48 | - | - | OKU0290009 | CHSTER20 |
| NKM0021820 | ER20 | 1:1 | 6000 | 50Nm | X | P=70bar | X | 80.66 | - | 59 | - | - | OKU0290009 | CHSTER20 |
| NKM0021420 | ERA20 | 1:1 | 6000 | 50Nm | X | - | X | 69.23 | - | 48 | - | - | OKU0290009 | CHUB22 |
| NKM0021520 | ERA20 | 1:1 | 6000 | 50Nm | X | P=70bar | X | 69.23 | - | 59 | - | - | OKU0290009 | CHUB22 |
| NKM0021425 | ER25 | 1:1 | 6000 | 50Nm | X | - | X | 82.16 | - | 48 | - | - | OKU0290009 | CHSTER25 |
| NKM0021625 | ER25 | 1:1 | 6000 | 50Nm | X | P=70bar | X | 82.16 | - | 59 | - | - | OKU0290009 | CHSTER25 |
| NKM0022432 | ER32 | 1:1 | 6000 | 50Nm | X | - | X | 92.16 | - | 48 | - | - | OKU0290009 | CHSTER32 |
| NKM0022532 | ER32 | 1:1 | 6000 | 50Nm | X | P=70bar | X | 92.16 | - | 59 | - | - | OKU0290009 | CHSTER32 |
| NKM0021617 | Ø16x17 | 1:1 | 6000 | 50Nm | X | - | X | - | 63 | 48 | 16 | 17 | CHUB36 | CH_VTCROCE_M08 |
| NKM0022219 | Ø22x19 | 1:1 | 6000 | 50Nm | X | - | X | - | 63 | 48 | 22 | 19 | CHUB36 | CH_VTCROCE_M10 |
| NKM0022721 | Ø27x21 | 1:1 | 6000 | 50Nm | X | - | X | - | 65.5 | 48 | 27 | 21 | CHUB36 | CH_VTCROCE_M12 |
| NKM0022737 | Ø27x37 | 1:1 | 6000 | 50Nm | X | - | X | - | 65.5 | 48 | 27 | 37 | CHUB36 | CH_VTCROCE_M12 |

NAKAMURA-TOME

WT150/250 - WT15011/25011 - WT150 - WTS150 - SUPER NTM3 - SUPER NTJ - SC150/200/250 - SC20011 12/16 ST. SC30011 16ST. - NTY3 150/250 - TW10M/MY/MM/MMY/MMYY-TW20M/MY/MM/MMY/MMYY 16ST. - WY150/250 - AS200 15/12 ST.

MODULO MOTORIZZATO ASSIALE H=55mm
Axial driven tool H=55mm
Axial angetriebenes Werkzeug H=55mm

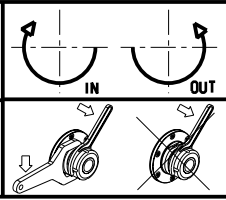

M.T. srl
Via Casino Albini 480
Tel. 0541/956034-957884
Fax 0541/956341
47842 S. GIOVANNI IN M. (RN)
e-mail: mtma@tmarchetti.com
http://www.tmmarchetti.com



NKM150-2-10

Subject to change without notice.