

- Chiave inclusa
- Key included
- Schluessel inbegriffen

| Cod. MT    | Mandrino<br>Spindle<br>Spindel | I   | RPM  | Coppia Max<br>Max Torque<br>Max Drehmoment | Reversibile lato<br>mandrino/contromandrino<br>Reversible sub/main<br>spindle side<br>Umkehrbare Spindelseite/<br>Gegenspindelseite | Lubrificazione est.<br>Ext. coolant<br>Aussenkuehlung | CHIAVI NON INCLUSE<br>Keys not included<br>Schluessel nicht einbegriffen |          |            |
|------------|--------------------------------|-----|------|--|---|---|--|----------|------------|
| NKM2103225 | ER32+ER25                      | 1:1 | 6000 | 50Nm                                       | X   | X   | CHSTER32   | CHSTER25 | OKU0650004 |

**NAKAMURA-TOME**

WT150/250 - WT15011/25011 - WTW150 - WTS150 - SUPER NTM3 - SUPER NTJ - SC150/200/250 - SC20011 12/16 ST.  
 SC30011 16ST. - NTY3 150/250 - TW10M/MY/MM/MMY/MMYY-TW20M/MY/MM/MMY/MMYY 16ST. - WY 150/250 - AS200 15/12 ST.

MODULO MOTORIZZATO ASSIALE BISPORGENTE H=65mm  
 Axial opposite face twin driven tool H=65mm  
 Axial angetriebenes Werkzeug halb vorspringend H=65mm

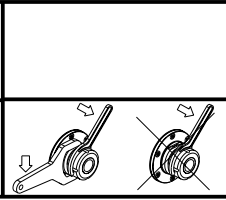

**M.T. srl**  
 Via Casino Albini 480  
 Tel. 0541/956034-957884  
 Fax 0541/956341  
 47842 S. GIOVANNI IN M. (RN)  
 e-mail: mtma@mtmarchetti.com  
 http://www.mtmarchetti.com



NKM240-2-15

Subject to change without notice.