

- Chiave inclusa
- Key included
- Schlüssel inbegriffen

Cod. MT	Cod. NAKAMURA	Mandrino Spindle Spindel	I	RPM	Coppia Max Max Torque Max Drehmoment	Lubrificazione int. Coolant through Innenkuhlung	Lubrificazione est. Ext. coolant Aussenkuhlung	A	A1	B	D	L	CHIAVI NON INCLUSE Keys not included Schlüssel nicht einbegriffen	
NKM0280125	-	ER25	1:1	6000	70Nm	-	X	48.66	-	15	-	-	CHUB42	CHSTER25
NKM0280132	G31330	ER32	1:1	6000	70Nm	-	X	56.16	-	15	-	-	OKU0650004 *	CHSTER32
NKM0280332	-	ER32	1:1	6000	70Nm	P=30bar	X	73.66	-	35	-	-	OKU0650004 *	CHSTER32
NKM0280140	-	ER40	1:1	6000	70Nm	-	X	65.16	-	15	-	-	OKU0650004 *	CHSTER40
NKM0280225	-	ER A 25	1:1	6000	70Nm	P=30bar	X	59.03	-	35	-	-	CHUB40	CHUB27
NKM0280232	-	ER A 32	1:1	6000	70Nm	P=30bar	X	67.53	-	35	-	-	CHUB46	CHUB32
NKM0281617	-	Ø16x17	1:1	6000	70Nm	-	X	-	25	15	16	17	CHUB42	CH_VTCROCE_M08 *
NKM0282219	G31380	Ø22x19	1:1	6000	70Nm	-	X	-	27	15	22	19	CHUB40	CH_VTCROCE_M10 *
NKM0282721	-	Ø27x21	1:1	6000	70Nm	-	X	-	28	15	27	21	CHUB40	CH_VTCROCE_M12 *
NKM0281919	-	Ø3/4"x3/4"	1:1	6000	70Nm	-	X	-	25	15	3/4"	3/4"	CHUB42	CH_VTCROCE_M08 *
NKM0282519	-	Ø1"x19	1:1	6000	70Nm	-	X	-	29	15	1"	19	CHUB40	CH_VTCROCE_M12 *

**NAKAMURA-TOME**

MOD: Super Mill W T150/W T15011/W Y250/SC 200L - SUPER NTY3 JUMBO

MODULO MOTORIZZATO RADIALE  
Radial driven tool  
Radial angetriebenes Werkzeug

Subject to change without notice.

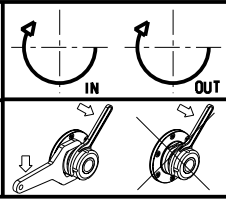

**M.T. srl**  
Via Casino Albini 480  
Tel. 0541/956034-957884  
Fax 0541/956341  
47842 S. GIOVANNI IN M. (RN)  
e-mail: mtma@mtmarchetti.com  
http://www.mtmarchetti.com



NKM010-4-00