

- Chiave inclusa
- Key included
- Schluessel inbegriffen

| Cod. MT     | Mandrino Spindle Spindel | I   | RPM  | Coppia Max Max Torque Max Drehmoment | Reversibile lato mandrino/contromandrino Reversible sub/main spindle side Umkehrbare Spindelseite/ Gegenspindelseite | Lubr.interna Coolant through Innenkuehlung | Lubr.esterna Ext. coolant Aussenkuehlung | A     | A1   | B  | D  | L  | CHIAVI NON INCLUDE<br>Keys not included<br>Schluessel nicht inbegriffen |                  |              |
|-------------|--------------------------|-----|------|--------------------------------------|--|--|--|-------|------|----|----|----|---|------------------|--------------|
| DW 00700125 | ER25                     | 1:1 | 6000 | 100Nm                                | X  | -  | X  | 91.16 | -    | 54 | -  | -  | -   | CHSTER25         | OKU0650004 ■ |
| DW 00700225 | ER25                     | 1:1 | 6000 | 100Nm                                | X  | P=70bar                                    | X  | 91.16 | -    | 65 | -  | -  | -   | CHSTER25         | OKU0650004 ■ |
| DW 00700132 | ER32                     | 1:1 | 6000 | 100Nm                                | X  | -  | X  | 93.66 | -    | 54 | -  | -  | -   | CHSTER32         | OKU0650004 ■ |
| DW 00700232 | ER32                     | 1:1 | 6000 | 100Nm                                | X  | P=70bar                                    | X  | 93.66 | -    | 65 | -  | -  | -   | CHSTER32         | OKU0650004 ■ |
| DW 00700140 | ER40                     | 1:1 | 6000 | 100Nm                                | X  | -  | X  | 98.16 | -    | 54 | -  | -  | -   | CHSTER40         | OKU0650004 ■ |
| DW 00700240 | ER40                     | 1:1 | 6000 | 100Nm                                | X  | P=70bar                                    | X  | 98.16 | -    | 65 | -  | -  | -   | CHSTER40         | OKU0650004 ■ |
| DW 00700325 | ERA25                    | 1:1 | 6000 | 100Nm                                | X  | -  | X  | 65    | -    | 54 | -  | -  | CHUB27  | CHTAER25ZC ■     | OKU0650004 ■ |
| DW 00700425 | ERA25                    | 1:1 | 6000 | 100Nm                                | X  | P=70bar                                    | X  | 65    | -    | 65 | -  | -  | CHUB27  | CHTAER25ZC ■     | OKU0650004 ■ |
| DW 00700516 | Ø16x17                   | 1:1 | 6000 | 100Nm                                | X  | -  | X  | -     | 67.5 | 54 | 16 | 17 | -   | CH_VTCROCE_M08 ■ | OKU0650004 ■ |
| DW 00700522 | Ø22x19                   | 1:1 | 6000 | 100Nm                                | X  | -  | X  | -     | 67.5 | 54 | 22 | 19 | -   | CH_VTCROCE_M10 ■ | OKU0650004 ■ |
| DW 00700527 | Ø27x21                   | 1:1 | 6000 | 100Nm                                | X  | -  | X  | -     | 70   | 54 | 27 | 21 | -   | CH_VTCROCE_M12 ■ | OKU0650004 ■ |

TAKISAWA  
MOD: NX-2500 12ST./15ST. (BMT65)

MODULO MOTORIZZATO ASSIALE H=72mm  
Axial driven tool H=72mm  
Axial angetriebenes Werkzeug H=72mm

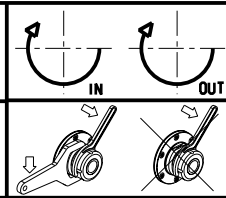

**M.T. srl**  
Via Casino Albini 480  
Tel. 0541/956034-957884  
Fax 0541/956341  
47842 S. GIOVANNI IN M. (RN)  
e-mail: mtma@mtmarchetti.com  
http://www.mtmarchetti.com



TKW 150-10-11

Subject to change without notice.

09/2024