

ATTENZIONE - ATTENTION - ACHTUNG

- Per lo smontaggio degli utensili utilizzare sempre la chiave di contrasto come indicato nel manuale d'uso.
- For disassembly of the tools use always the contrast key as mentioned in the user instructions.
- Fuer das Abmontieren der Werkzeuge immer den Gegenschlüssel benutzen wie in der Bedienungsanleitung erwaeht.

- Chiave inclusa
- Key included
- Schlüssel inbegriffen

Cod. MT	Cod. TAKISAWA	Mandrino Spindle Spindel	I	RPM	Coppia Max Max Torque Max Drehmoment	Lubr.interna Coolant through Innenkuehlung	Lubr.esterna Ext. coolant Aussenkuehlung	A	A1	B	D	L	CHIAVI NON INCLUDE Keys not included Schluesssel nicht einbegriffen		
TKW 014 1125	-	ER25	1:1	6000	65Nm	-	X	91.16	-	54.5	-	-	-	CHSTER25	OKU0650004 •
TKW 014 1132	GM81998-642L	ER32	1:1	6000	65Nm	-	X	93.66	-	54.5	-	-	-	CHSTER32	OKU0650004 •
TKW 014 1140	-	ER40	1:1	6000	65Nm	-	X	98.16	-	54.5	-	-	-	CHSTER40	OKU0650004 •
TKW 014 1325	-	ERA25	1:1	6000	65Nm	-	X	65	-	54.5	-	-	CHUB27	CHTAER25ZC •	OKU0650004 •
TKW 014 1225	-	ER25	1:1	6000	65Nm	P=70bar	X	91.16	-	67	-	-	-	CHSTER25	OKU0650004 •
TKW 014 1232	-	ER32	1:1	6000	65Nm	P=70bar	X	93.66	-	67	-	-	-	CHSTER32	OKU0650004 •
TKW 014 1240	-	ER40	1:1	6000	65Nm	P=70bar	X	98.16	-	67	-	-	-	CHSTER40	OKU0650004 •
TKW 014 14 25	-	ERA25	1:1	6000	65Nm	P=70bar	X	65	-	67	-	-	CHUB27	CHTAER25ZC •	OKU0650004 •
TKW 014 1516	-	Ø16x17	1:1	6000	65Nm	-	X	-	67.5	54.5	16	17	-	CH_VTCROCE_M08	OKU0650004 •
TKW 014 1522	-	Ø22x19	1:1	6000	65Nm	-	X	-	67.5	54.5	22	19	-	CH_VTCROCE_M10	OKU0650004 •
TKW 014 1527	-	Ø27x21	1:1	6000	65Nm	-	X	-	70	54.5	27	21	-	CH_VTCROCE_M12	OKU0650004 •

TAKISAWA
MOD: TMM200/250 - TNR200

MODULO MOTORIZZATO ASSIALE PER CONTROMANDRINO VD140
Axial driven tool for subspindle VD140
Axial angetriebenes Werkzeug fuer Gegenspindel VD140

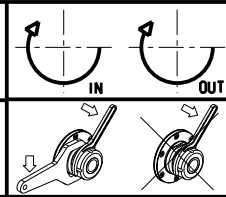

M.T. srl
Via Casino Albini 480
Tel. 0541/956034-957884
Fax 0541/956341
47842 S. GIOVANNI IN M. (RN)
e-mail: mtma@mtmarchetti.com
http://www.mtmarchetti.com



TKW 155-3-15

Subject to change without notice.