

- Chiave inclusa
- Key included
- Schlüssel inbegriffen

Cod. MT	Mandrino Spindle Spindel	I	RPM	Coppia Max Max Torque Max Drehmoment	Lubrificazione int. Coolant through Innenkuehlung	Lubrificazione est. Ext. coolant Aussekuehlung	ØD	L	A1	A2	A3	B	CHIAVI NON INCLUDE Keys not included Schlüssel nicht einbegriffen		
SAU0170125	ER25	1:1	6000	32Nm		X			80.66			56	-	CHSTER25	OKU0290009 *
SAU0171125	ER25	1:1	6000	32Nm	P=30bar	X			94.66			70	-	CHSTER25	OKU0290009 *
SAU0170225	ERA25	1:1	6000	32Nm		X			61			56	CHUB27	CHTAER25ZC *	OKU0290009 *
SAU0171225	ERA25	1:1	6000	32Nm	P=30bar	X			75			70	CHUB27	CHTAER25ZC *	OKU0290009 *
SAU0170316	WELDON16	1:1	6000	32Nm		X					66.5	56	-	-	-
SAU0171316	WELDON16	1:1	6000	32Nm	P=30bar	X					80	70	-	-	-
SAU0170416	Ø16x17	1:1	6000	32Nm		X	16	17		59.5		56	-	CH_VTCROCE_M08 *	OKU0290009 *
SAU0170422	Ø22x19	1:1	6000	32Nm		X	22	19		61.5		56	-	CH_VTCROCE_M10 *	OKU0290009 *

SAUTER  
VDI 30

MODULO MOTORIZZATO ASSIALE VDI30 DIN 5482  
Axial driven tool VDI30 DIN 5482  
Axial angetriebenes Werkzeug VDI30 DIN 5482

Subject to change without notice.

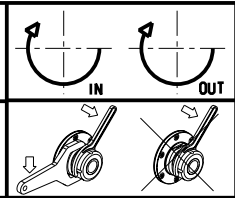

**M.T. srl**  
Via Casino Albini 480  
Tel. 0541/956034-957884  
Fax 0541/956341  
47842 S. GIOVANNI IN M. (RN)  
e-mail: mtma@mtmarchetti.com  
http://www.mtmarchetti.com



SAU014-2-00