

-LA FUNZIONE DI POLIGONATURA/DENTATURA DEVE ESSERE INSTALLATA SULLA MACCHINA
 -POLYGON CUTTING/GEAR HOBBING FUNCTION MUST BE INSTALLED ON THE MACHINE
 -DIE FUNKTION FÜR POLYGON-BZW. VERZÄHNUNGSFRÄSEN MUSS AUF DER MASCHINE FREIGESCHALTET WERDEN

DOTAZIONI - SUPPLIED WITH - AUSSTATTUNG

- N°1 ALBERO + DISTANZIALI
- N°1 SHAFT + SPACER
- N°1 DORN + ABSTANDSSTUECK

PER ALBERI E DISTANZIALI VEDI PAG. TBL250-1-00
 FOR SHAFT END SPACER SEE PAGE TBL250-1-00
 FUER DORN UND ABSTANDSSTUECK SEITE TBL250-1-00

| Cod. MT | I | RPM MAX | Coppia Max Max Torque Max Drehmoment | Lubrificazione est. Ext. coolant Aussenkuehlung | D (mm) | D (Inch) | CHIAVI INCLUSE Keys included Schlüssel inbegriffen | | | |
|------------|-----|------------|--|---|-------------|----------------|--|---------|---------|----------------------|
| | | | | | | | CHUB30 | CHESL08 | CHESL10 | CHUB24 (Ø16 / Ø3/4") |
| DW00181100 | 1:1 | 3000 | 90Nm | X | 16-22-27-32 | 3/4"-1"-1 1/4" | CHUB30 | CHESL08 | CHESL10 | CHUB24 (Ø16 / Ø3/4") |
| DW00182100 | 2:1 | 1500 | 110Nm | X | 16-22-27-32 | 3/4"-1"-1 1/4" | CHUB30 | CHESL08 | CHESL10 | CHUB24 (Ø16 / Ø3/4") |

VICTOR
 MOD: VTURN-V1000 (CM)

MODULO MOTORIZZATO PORTACREATORE MAGGIORATO
 Reinforced driven gear hobber
 Angetriebenes Zahnradwaelzfraes-Werkzeug vergroessert

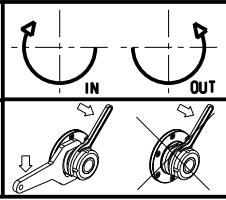

M.T. srl
 Via Casino Albini 480
 Tel. 0541/956034-957884
 Fax 0541/956341
 47842 S. GIOVANNI IN M. (RN)
 e-mail: mtma@mtmarchetti.com
 http://www.mtmarchetti.com



VCT340-4-60

Subject to change without notice.